

## Spring plungers with slot and thrust pin, light spring force

### Item description/product images



### Description

#### Material:

Sleeve 1.4305.  
Thrust pin 1.4034.  
Spring 1.4310.

#### Version:

Bright.  
Thrust pin hardened.

### Drawings

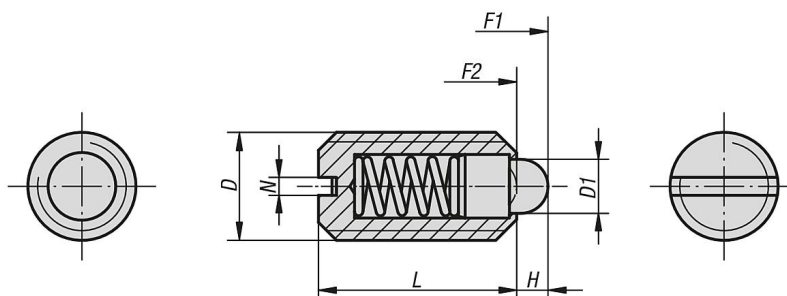

### Overview of items

#### Spring plungers with slot and thrust pin, light spring force

Order No.	Main material	D	D1	H	L	N	Spring force initial pressure F1 approx. N	Spring force final pressure F2 approx. N
K0314.105	stainless steel	M5	2,4	2	12	0,8	3	10
K0314.106	stainless steel	M6	2,7	2	14	1	4	10
K0314.104	stainless steel	M4	1,8	1,5	9	0,6	3	10
K0314.110	stainless steel	M10	4,5	2,5	19	1,6	9	16
K0314.112	stainless steel	M12	6	3,5	22	2	14	26
K0314.116	stainless steel	M16	8,5	4,5	24	2,5	22	50
K0314.108	stainless steel	M8	4	2	16	1,2	7	15
K0314.120	stainless steel	M20	10	6,5	30	2,5	30	60