

# Tombstones cube without grid holes

## Item description/product images



## Description

**Material:**  
GJL 300.

**Version:**  
Reference surfaces precision machined.  
The clamping surfaces have 0.5 mm allowance.

**Note:**  
The cube tombstones are matched to subplates for machine tools acc. to DIN 55201 and JIS 6337-1980.  
Ring bolts for lifting are supplied. A cover prevents the cavities filling with swarf.

## Drawings

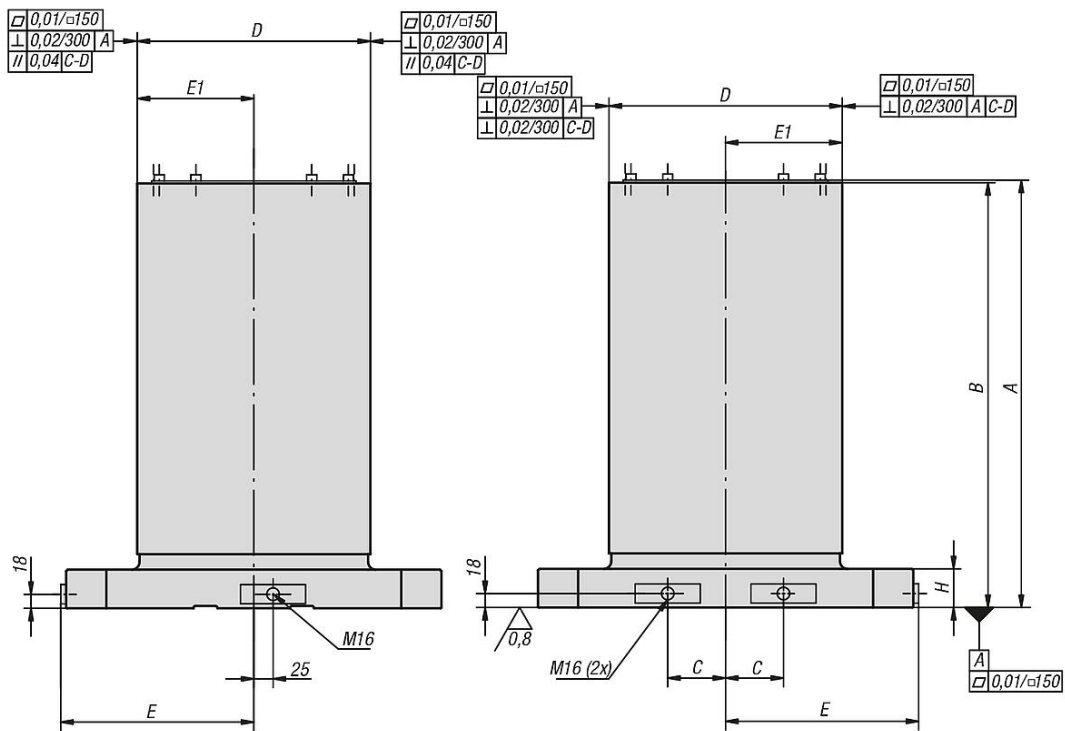

# Tombstones cube without grid holes

## Drawings

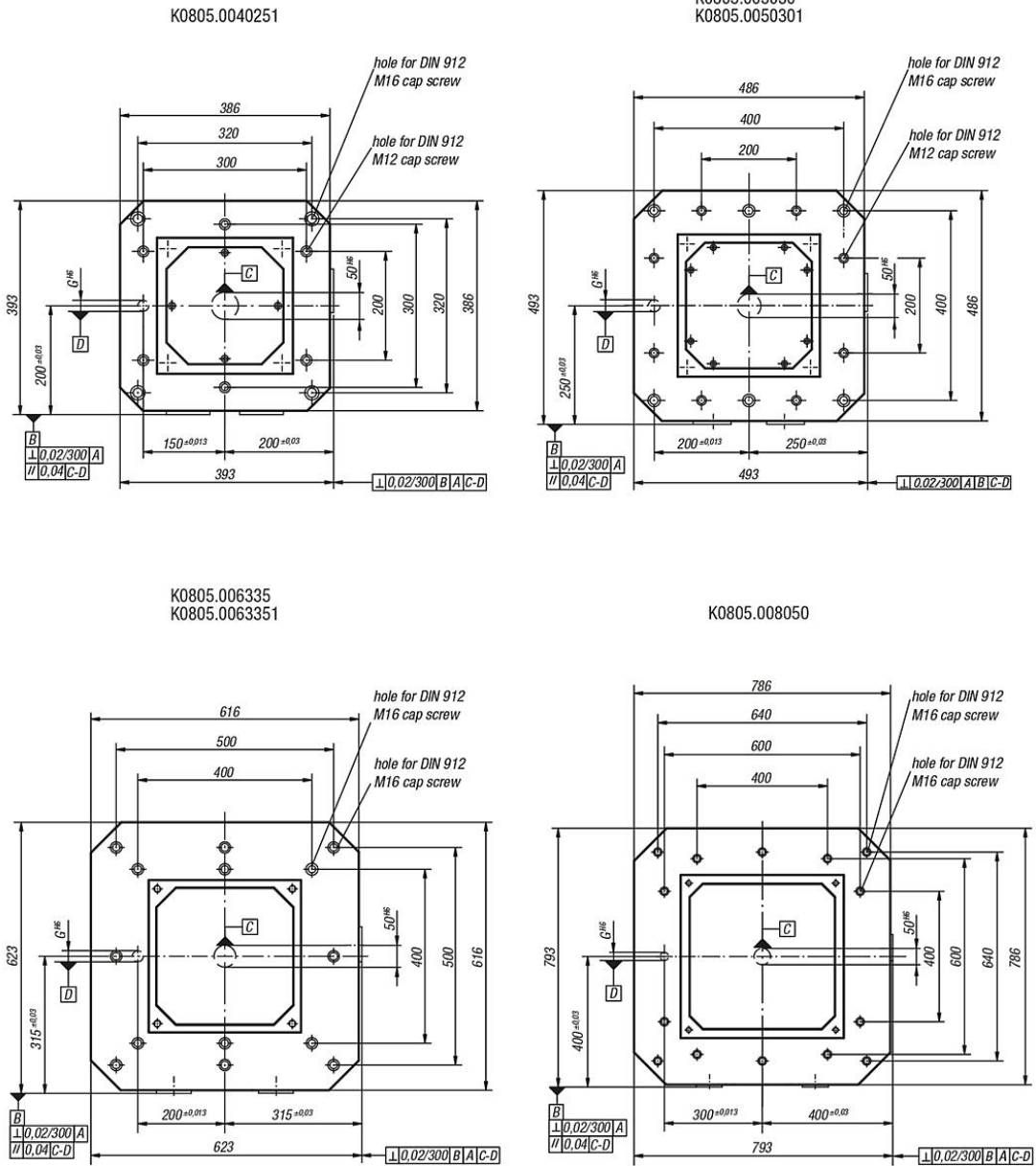

## Overview of items

### Cube tombstones without grid holes

Order No.	A	B	C	D	E	E1	G	H	weight ca. kg
K0805.0040251	553	550	55	251±0,2	200	125,5 ±0,2	20	50	183
K0805.005030	553	550	75	301±0,2	250	150,5 ±0,2	20	50	231
K0805.0050301	653	650	75	301±0,2	250	150,5 ±0,2	20	50	268