

# Rubber buffers stainless steel type E cylindrical with internal thread, grey

Item description/product images



## Description

### Material:

Metal parts 1.4401 stainless steel.

Elastomer natural rubber, medium hardness Shore 55A, grey.

### Version:

Stainless steel bright.

### Note:

Rubber buffers are widely-used construction elements for elastic mounting. They are used, among other things, as mountings for aggregates, motors, compressors, pumps and testing machinery.

### Temperature range:

-30 °C to +80 °C

### On request:

Metal parts 1.4301 stainless steel.

## Drawings

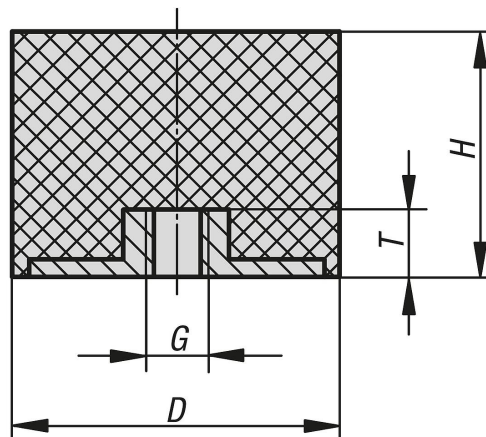

## Overview of items

### Rubber buffers, stainless steel, type E

Order No.	Main material	Component colour	D	H	G	T	Spring stiffness N/mm	Load N
K1319.00800855	stainless steel	grey	8	8	M3	3	88	44
K1319.01501255	stainless steel	grey	15	12	M4	4	165	182
K1319.01501555	stainless steel	grey	15	15	M4	4	100	130
K1319.01502055	stainless steel	grey	15	20	M4	4	75	113
K1319.02001555	stainless steel	grey	20	15	M6	5	145	246
K1319.02002055	stainless steel	grey	20	20	M6	5	94	216
K1319.02002555	stainless steel	grey	20	25	M6	5	65	169
K1319.02501555	stainless steel	grey	25	15	M8	7	270	540
K1319.02502555	stainless steel	grey	25	25	M8	7	105	315
K1319.02503055	stainless steel	grey	25	30	M8	7	85	281
K1319.02504055	stainless steel	grey	25	40	M8	7	75	300
K1319.03001555	stainless steel	grey	30	15	M8	7	545	491

# Rubber buffers stainless steel type E cylindrical with internal thread, grey

## Overview of items

Order No.	Main material	Component colour	D	H	G	T	Spring stiffness N/mm	Load N
K1319.03002555	stainless steel	grey	30	25	M8	7	160	416
K1319.03003055	stainless steel	grey	30	30	M8	7	125	425
K1319.03004055	stainless steel	grey	30	40	M8	7	85	315
K1319.04002055	stainless steel	grey	40	20	M8	7	550	660
K1319.04002555	stainless steel	grey	40	25	M8	7	500	1000
K1319.04003055	stainless steel	grey	40	30	M8	7	300	870
K1319.04004055	stainless steel	grey	40	40	M8	7	260	1040
K1319.05002055	stainless steel	grey	50	20	M10	8	860	860
K1319.05002555	stainless steel	grey	50	25	M10	8	700	1400
K1319.05003055	stainless steel	grey	50	30	M10	8	450	1575
K1319.05004055	stainless steel	grey	50	40	M10	8	350	1400
K1319.05005055	stainless steel	grey	50	50	M10	8	170	850
K1319.06003055	stainless steel	grey	60	30	M10	8	700	1400
K1319.06004055	stainless steel	grey	60	40	M10	8	400	1600
K1319.06005055	stainless steel	grey	60	50	M10	8	240	1200
K1319.07004255	stainless steel	grey	70	42	M10	8	520	2600
K1319.07004555	stainless steel	grey	70	45	M10	8	680	3060
K1319.07502555	stainless steel	grey	75	25	M12	10	1211	1816
K1319.07503055	stainless steel	grey	75	30	M12	10	1090	2289
K1319.07504055	stainless steel	grey	75	40	M12	10	500	2000
K1319.07505055	stainless steel	grey	75	50	M12	10	550	2750