

Grub screw with hexagon socket and pointed end DIN EN ISO 4027

Item description/product images



Description

Material:

Steel or stainless steel A2.

Version:

Steel class 45 H, black.

Stainless steel A2-70, bright.

Note:

By M4x5, M5x5, M5x6, M6x6, M8x8, M10x10 the point angle is 120°.

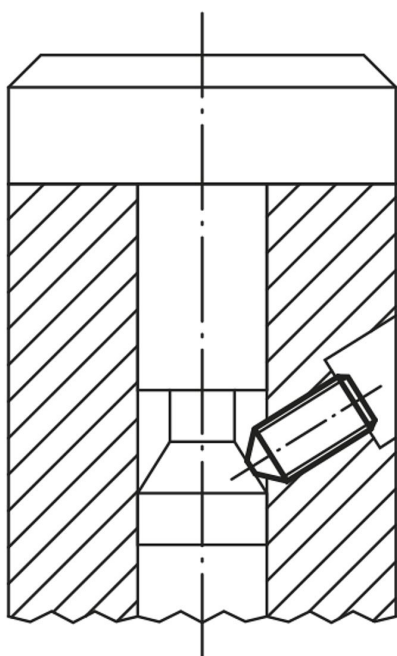

Drawings

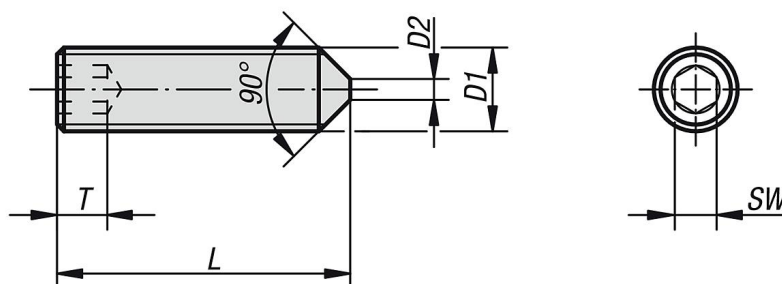

Overview of items

Grub screw with hexagon socket and pointed end, DIN EN ISO 4027

Grub screw with hexagon socket and pointed end DIN EN ISO 4027

Overview of items

Order No.	Material	D1	D2	L	T	SW
K0797.03X5	steel	M3	-	5	1,2	1,5
K0797.03X6	steel	M3	-	6	1,2	1,5
K0797.03X8	steel	M3	-	8	1,2	1,5
K0797.03X10	steel	M3	-	10	1,2	1,5
K0797.03X12	steel	M3	-	12	1,2	1,5
K0797.03X16	steel	M3	-	16	1,2	1,5
K0797.03X20	steel	M3	-	20	1,2	1,5
K0797.04X5	steel	M4	-	5	1,5	2
K0797.04X6	steel	M4	-	6	1,5	2
K0797.04X8	steel	M4	-	8	1,5	2
K0797.04X10	steel	M4	-	10	1,5	2
K0797.04X12	steel	M4	-	12	1,5	2
K0797.04X16	steel	M4	-	16	1,5	2
K0797.04X20	steel	M4	-	20	1,5	2
K0797.04X25	steel	M4	-	25	1,5	2
K0797.05X5	steel	M5	-	5	2	2,5
K0797.05X6	steel	M5	-	6	2	2,5
K0797.05X8	steel	M5	-	8	2	2,5
K0797.05X10	steel	M5	-	10	2	2,5
K0797.05X12	steel	M5	-	12	2	2,5
K0797.05X14	steel	M5	-	14	2	2,5
K0797.05X16	steel	M5	-	16	2	2,5
K0797.05X20	steel	M5	-	20	2	2,5
K0797.05X25	steel	M5	-	25	2	2,5
K0797.05X30	steel	M5	-	30	2	2,5
K0797.06X6	steel	M6	1,5	6	2	3
K0797.06X8	steel	M6	1,5	8	2	3
K0797.06X10	steel	M6	1,5	10	2	3
K0797.06X12	steel	M6	1,5	12	2	3
K0797.06X16	steel	M6	1,5	16	2	3
K0797.06X20	steel	M6	1,5	20	2	3
K0797.06X25	steel	M6	1,5	25	2	3
K0797.06X30	steel	M6	1,5	30	2	3
K0797.06X35	steel	M6	1,5	35	2	3
K0797.06X40	steel	M6	1,5	40	2	3
K0797.06X45	steel	M6	1,5	45	2	3
K0797.08X8	steel	M8	2	8	3	4
K0797.06X50	steel	M6	1,5	50	2	3
K0797.06X60	steel	M6	1,5	60	2	3
K0797.08X10	steel	M8	2	10	3	4
K0797.08X12	steel	M8	2	12	3	4
K0797.08X14	steel	M8	2	14	3	4
K0797.08X16	steel	M8	2	16	3	4
K0797.08X20	steel	M8	2	20	3	4
K0797.08X25	steel	M8	2	25	3	4
K0797.08X30	steel	M8	2	30	3	4
K0797.08X35	steel	M8	2	35	3	4
K0797.08X40	steel	M8	2	40	3	4
K0797.08X45	steel	M8	2	45	3	4
K0797.08X50	steel	M8	2	50	3	4
K0797.08X60	steel	M8	2	60	3	4
K0797.10X10	steel	M10	2,5	10	4	5
K0797.10X12	steel	M10	2,5	12	6	5
K0797.10X16	steel	M10	2,5	16	6	5
K0797.10X20	steel	M10	2,5	20	6	5
K0797.10X25	steel	M10	2,5	25	6	5
K0797.10X30	steel	M10	2,5	30	6	5
K0797.10X35	steel	M10	2,5	35	6	5
K0797.10X40	steel	M10	2,5	40	6	5
K0797.10X45	steel	M10	2,5	45	6	5
K0797.10X50	steel	M10	2,5	50	6	5
K0797.10X60	steel	M10	2,5	60	6	5

Grub screw with hexagon socket and pointed end DIN EN ISO 4027

Overview of items

Order No.	Material	D1	D2	L	T	SW
K0797.10X70	steel	M10	2,5	70	6	5
K0797.10X80	steel	M10	2,5	80	6	5
K0797.103X5	stainless steel	M3	-	5	1,2	1,5
K0797.103X6	stainless steel	M3	-	6	1,2	1,5
K0797.103X8	stainless steel	M3	-	8	1,2	1,5
K0797.103X10	stainless steel	M3	-	10	1,2	1,5
K0797.103X12	stainless steel	M3	-	12	1,2	1,5
K0797.103X16	stainless steel	M3	-	16	1,2	1,5
K0797.103X20	stainless steel	M3	-	20	1,2	1,5
K0797.104X5	stainless steel	M4	-	5	1,5	2
K0797.104X6	stainless steel	M4	-	6	1,5	2
K0797.104X8	stainless steel	M4	-	8	1,5	2
K0797.104X10	stainless steel	M4	-	10	1,5	2
K0797.104X12	stainless steel	M4	-	12	1,5	2
K0797.104X16	stainless steel	M4	-	16	1,5	2
K0797.104X20	stainless steel	M4	-	20	1,5	2
K0797.104X25	stainless steel	M4	-	25	1,5	2
K0797.105X5	stainless steel	M5	-	5	2	2,5
K0797.105X6	stainless steel	M5	-	6	2	2,5
K0797.105X8	stainless steel	M5	-	8	2	2,5
K0797.105X10	stainless steel	M5	-	10	2	2,5
K0797.105X12	stainless steel	M5	-	12	2	2,5
K0797.105X14	stainless steel	M5	-	14	2	2,5
K0797.105X16	stainless steel	M5	-	16	2	2,5
K0797.105X20	stainless steel	M5	-	20	2	2,5
K0797.105X25	stainless steel	M5	-	25	2	2,5
K0797.105X30	stainless steel	M5	-	30	2	2,5
K0797.106X6	stainless steel	M6	1,5	6	2	3
K0797.106X8	stainless steel	M6	1,5	8	2	3
K0797.106X10	stainless steel	M6	1,5	10	2	3
K0797.106X12	stainless steel	M6	1,5	12	2	3
K0797.106X16	stainless steel	M6	1,5	16	2	3
K0797.106X20	stainless steel	M6	1,5	20	2	3
K0797.106X25	stainless steel	M6	1,5	25	2	3
K0797.106X30	stainless steel	M6	1,5	30	2	3
K0797.106X35	stainless steel	M6	1,5	35	2	3
K0797.106X40	stainless steel	M6	1,5	40	2	3
K0797.106X45	stainless steel	M6	1,5	45	2	3
K0797.106X50	stainless steel	M6	1,5	50	2	3
K0797.106X60	stainless steel	M6	1,5	60	2	3
K0797.108X8	stainless steel	M8	2	8	3	4
K0797.108X10	stainless steel	M8	2	10	3	4
K0797.108X12	stainless steel	M8	2	12	3	4
K0797.108X14	stainless steel	M8	2	14	3	4
K0797.108X16	stainless steel	M8	2	16	3	4
K0797.108X20	stainless steel	M8	2	20	3	4
K0797.108X25	stainless steel	M8	2	25	3	4
K0797.108X30	stainless steel	M8	2	30	3	4
K0797.108X35	stainless steel	M8	2	35	3	4
K0797.108X40	stainless steel	M8	2	40	3	4
K0797.108X45	stainless steel	M8	2	45	3	4
K0797.108X50	stainless steel	M8	2	50	3	4
K0797.108X60	stainless steel	M8	2	60	3	4
K0797.110X10	stainless steel	M10	2,5	10	4	5
K0797.110X12	stainless steel	M10	2,5	12	6	5
K0797.110X16	stainless steel	M10	2,5	16	6	5
K0797.110X20	stainless steel	M10	2,5	20	6	5
K0797.110X25	stainless steel	M10	2,5	25	6	5
K0797.110X30	stainless steel	M10	2,5	30	6	5
K0797.110X35	stainless steel	M10	2,5	35	6	5
K0797.110X40	stainless steel	M10	2,5	40	6	5
K0797.110X45	stainless steel	M10	2,5	45	6	5

Grub screw with hexagon socket and pointed end DIN EN ISO 4027

Overview of items

Order No.	Material	D1	D2	L	T	SW
K0797.110X50	stainless steel	M10	2,5	50	6	5
K0797.110X60	stainless steel	M10	2,5	60	6	5
K0797.110X70	stainless steel	M10	2,5	70	6	5
K0797.110X80	stainless steel	M10	2,5	80	6	5