

## Subplates, grey cast iron with grid holes

### Item description/product images

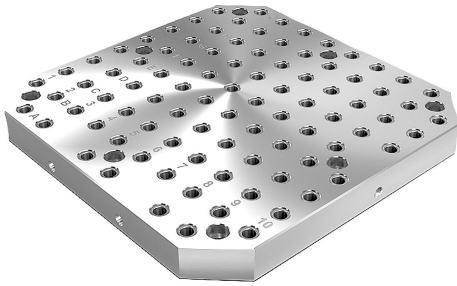

1)

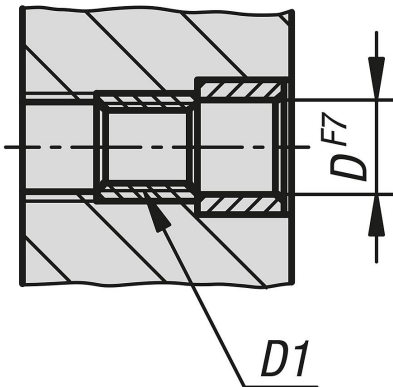

### Description

**Material:**  
GJL 300.

**Version:**  
Support and mounting surfaces ground

**Note:**

Grid spacing  $50 \pm 0.02$  mm.

Plates with grid holes are used for constructing modular fixtures. These plates are positioned and fastened directly on machine tables.

The alphanumerically labelled grid holes guarantee a defined assignment of clamping elements by repeat setups.

The subplates conform to machine tables for machine tools acc. to DIN 55201 and JIS 6337-1980.

Please order locating pins for positioning subplates on machine tables acc. to DIN 55201 separately.

Please order protection plugs to plug unused grid holes separately.

Ring bolts for hoisting are supplied.

Other dimensions available on request.

**Drawing reference:**

- 1) grid hole
- 2) hole for DIN 912 cap screw (D3/D4)

Subplates, grey cast iron with grid holes

Drawings

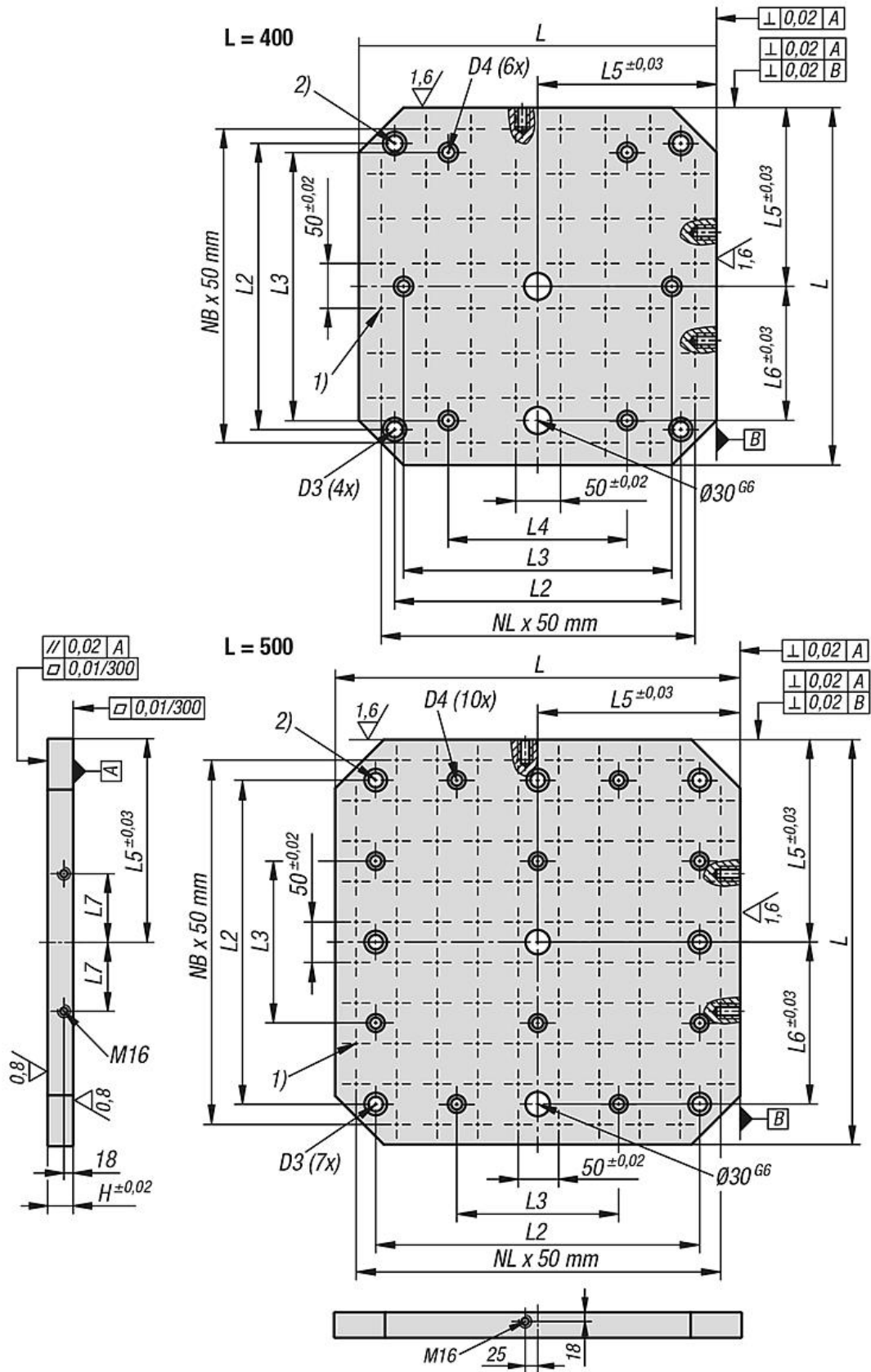

Subplates, grey cast iron with grid holes

Drawings

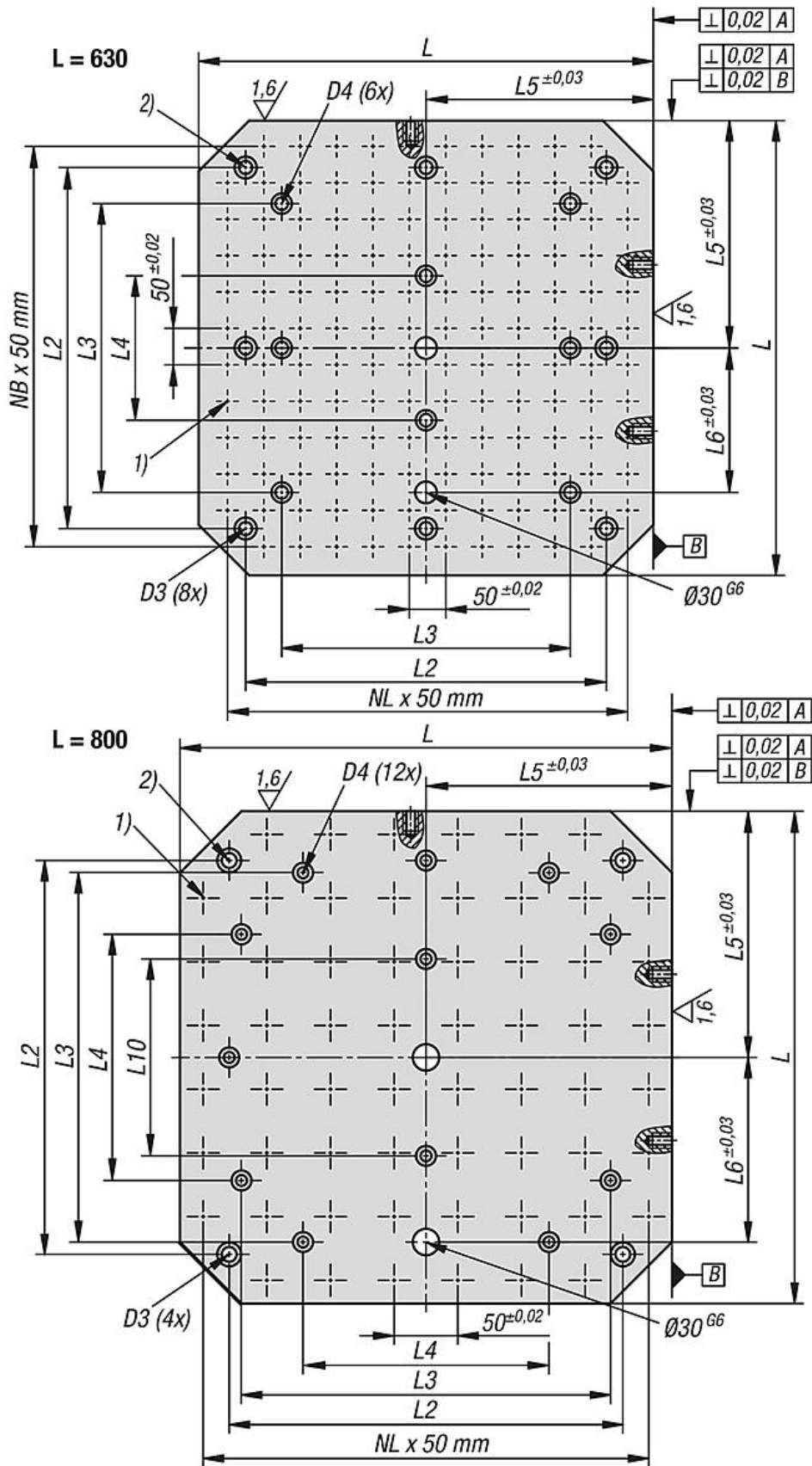

## Subplates, grey cast iron with grid holes

### Overview of items

#### Subplates, grey cast iron with grid holes

Order No.	L	H	D	D1	D3	D4	L2	L3	L4	L5	L6	L7	L10	N1=No. of grid holes	NL=No. lengthwise	NB= No. across
<b>K0806.2124040</b>	400	50	12	M12	M16	M12	320	300	200	200	150	55	-	59	7	7
<b>K0806.2125050</b>	500	50	12	M12	M16	M12	400	200	-	250	200	75	-	93	9	9
<b>K0806.2126363</b>	630	50	12	M12	M16	M16	500	400	200	315	200	100	-	139	11	11
<b>K0806.2128080</b>	800	50	12	M12	M16	M16	640	600	400	400	300	135	320	237	15	15
<b>K0806.2164040</b>	400	50	16	M16	M16	M12	320	300	200	200	150	55	-	59	7	7
<b>K0806.2165050</b>	500	50	16	M16	M16	M12	400	200	-	250	200	75	-	93	9	9
<b>K0806.2166363</b>	630	50	16	M16	M16	M16	500	400	200	315	200	100	-	139	11	11
<b>K0806.2168080</b>	800	50	16	M16	M16	M16	640	600	400	400	300	135	320	237	15	15