

## Star grips, plastic with protruding steel bush, Form L, external thread

### Item description/product images

---



### Description

**Product description:**

The thermoset star grip is distinguished by its closed grip contour. The contact surface of the protruding steel bush is vertical to the thread axis and ensures a firm screw connection.

**Material:**

Thermoset PF 31.

Steel grade 5.8 or stainless steel 1.4305.

**Version:**

Thermoset black, high-gloss polished.

Metal parts trivalent blue passivated steel or bright stainless steel.

**Advantages:**

Wear resistant contact surface

Closed grip contour

**On request:**

Form H: bush with blind hole

# Star grips, plastic with protruding steel bush, Form L, external thread

## Drawings

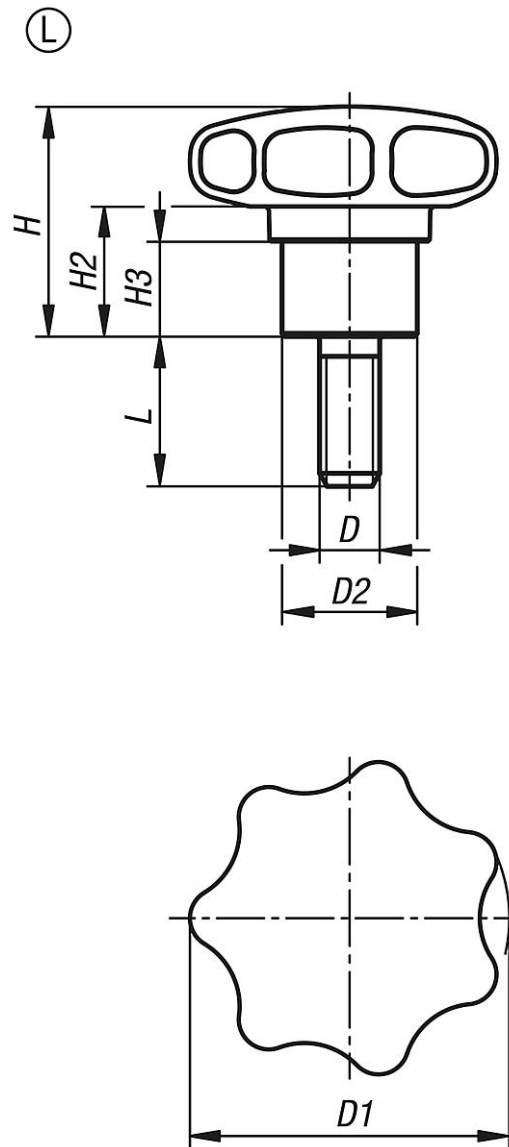

## Overview of items

Order No.	Component material	Form	D	D1	D2	H	H2	H3	L
K1514.43206X10	steel	L	M6	32	13,5	23	13	9,5	10
K1514.43206X15	steel	L	M6	32	13,5	23	13	9,5	15
K1514.43206X20	steel	L	M6	32	13,5	23	13	9,5	20
K1514.43206X25	steel	L	M6	32	13,5	23	13	9,5	25
K1514.43206X30	steel	L	M6	32	13,5	23	13	9,5	30
K1514.44008X15	steel	L	M8	40	13,5	25	13	10	15
K1514.44008X20	steel	L	M8	40	13,5	25	13	10	20
K1514.44008X25	steel	L	M8	40	13,5	25	13	10	25
K1514.44008X30	steel	L	M8	40	13,5	25	13	10	30
K1514.44008X40	steel	L	M8	40	13,5	25	13	10	40
K1514.44008X50	steel	L	M8	40	13,5	25	13	10	50
K1514.45010X20	steel	L	M10	50	19	32	17	12	20
K1514.45010X25	steel	L	M10	50	19	32	17	12	25
K1514.45010X30	steel	L	M10	50	19	32	17	12	30
K1514.45010X40	steel	L	M10	50	19	32	17	12	40
K1514.45010X50	steel	L	M10	50	19	32	17	12	50
K1514.45010X60	steel	L	M10	50	19	32	17	12	60

## Star grips, plastic with protruding steel bush, Form L, external thread

### Overview of items

Order No.	Component material	Form	D	D1	D2	H	H2	H3	L
K1514.46312X20	steel	L	M12	63	19	40	20	15	20
K1514.46312X25	steel	L	M12	63	19	40	20	15	25
K1514.46312X30	steel	L	M12	63	19	40	20	15	30
K1514.46312X40	steel	L	M12	63	19	40	20	15	40
K1514.46312X50	steel	L	M12	63	19	40	20	15	50
K1514.46312X60	steel	L	M12	63	19	40	20	15	60
K1514.53206X10	stainless steel	L	M6	32	13,5	23	13	9,5	10
K1514.53206X15	stainless steel	L	M6	32	13,5	23	13	9,5	15
K1514.53206X20	stainless steel	L	M6	32	13,5	23	13	9,5	20
K1514.53206X25	stainless steel	L	M6	32	13,5	23	13	9,5	25
K1514.53206X30	stainless steel	L	M6	32	13,5	23	13	9,5	30
K1514.54008X15	stainless steel	L	M8	40	13,5	25	13	10	15
K1514.54008X20	stainless steel	L	M8	40	13,5	25	13	10	20
K1514.54008X25	stainless steel	L	M8	40	13,5	25	13	10	25
K1514.54008X30	stainless steel	L	M8	40	13,5	25	13	10	30
K1514.54008X40	stainless steel	L	M8	40	13,5	25	13	10	40
K1514.54008X50	stainless steel	L	M8	40	13,5	25	13	10	50
K1514.55010X20	stainless steel	L	M10	50	19	32	17	12	20
K1514.55010X25	stainless steel	L	M10	50	19	32	17	12	25
K1514.55010X30	stainless steel	L	M10	50	19	32	17	12	30
K1514.55010X40	stainless steel	L	M10	50	19	32	17	12	40
K1514.55010X50	stainless steel	L	M10	50	19	32	17	12	50
K1514.55010X60	stainless steel	L	M10	50	19	32	17	12	60
K1514.56312X20	stainless steel	L	M12	63	19	40	20	15	20
K1514.56312X25	stainless steel	L	M12	63	19	40	20	15	25
K1514.56312X30	stainless steel	L	M12	63	19	40	20	15	30
K1514.56312X40	stainless steel	L	M12	63	19	40	20	15	40
K1514.56312X50	stainless steel	L	M12	63	19	40	20	15	50
K1514.56312X60	stainless steel	L	M12	63	19	40	20	15	60