

Stainless steel hinges with fastening screws, Form B

Item description/product images



Description

Material:

Stainless steel 1.4301.

Version:

Polished or blasted.

Note:

The high quality stainless steel hinges with fastening screws have an opening angle of 95°. The hinges can be used in the foodstuff, packaging, chemical and pharmaceutical industries.

The hinges are available in polished or abrasive blasted versions.

Drawings

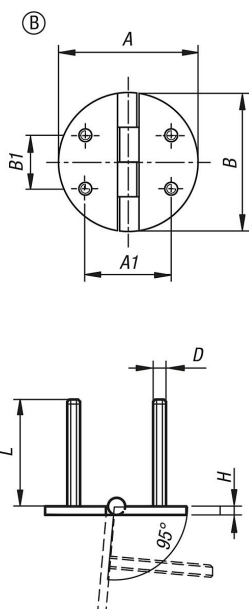

Overview of items

Order No.	Form	Form definition	Surface finish body	A	A1	A2	A3	B	B1	H	D	L
K1810.65650	B	round	polished	65	40	-	-	65	25	4	M6	50
K1810.65651	B	round	blasted	65	40	-	-	65	25	4	M6	50