

Spring plungers with slot and thrust pin, standard spring force

Item description/product images



Description

Material:

Sleeve 1.4305.
Thrust pin 1.4034.
Spring 1.4310.

Version:

Bright.
Thrust pin hardened.

Drawings

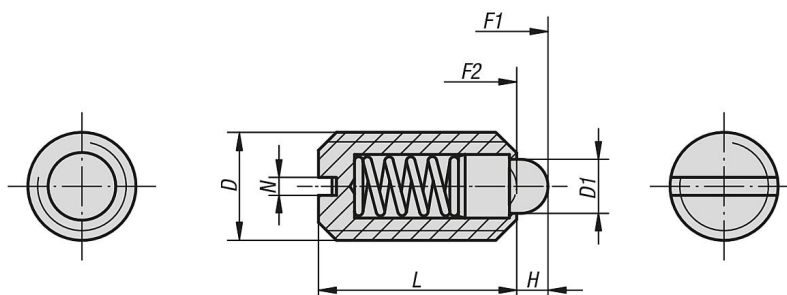

Overview of items

Spring plungers with slot and thrust pin, standard spring force

Order No.	Main material	D	D1	H	L	N	Spring force initial pressure F1 approx. N	Spring force final pressure F2 approx. N
K0314.04	stainless steel	M4	1,8	1,5	9	0,6	6	20
K0314.05	stainless steel	M5	2,4	2	12	0,8	6	20
K0314.06	stainless steel	M6	2,7	2	14	1	7	20
K0314.08	stainless steel	M8	4	2	16	1,2	15	30
K0314.10	stainless steel	M10	4,5	2,5	19	1,6	20	35
K0314.12	stainless steel	M12	6	3,5	22	2	30	55
K0314.16	stainless steel	M16	8,5	4,5	24	2,5	45	100
K0314.20	stainless steel	M20	10	6,5	30	2,5	60	120